

SHELTER ASSEMBLY MANUAL

Model # **C2040S**
W6 x L12 x H 2m

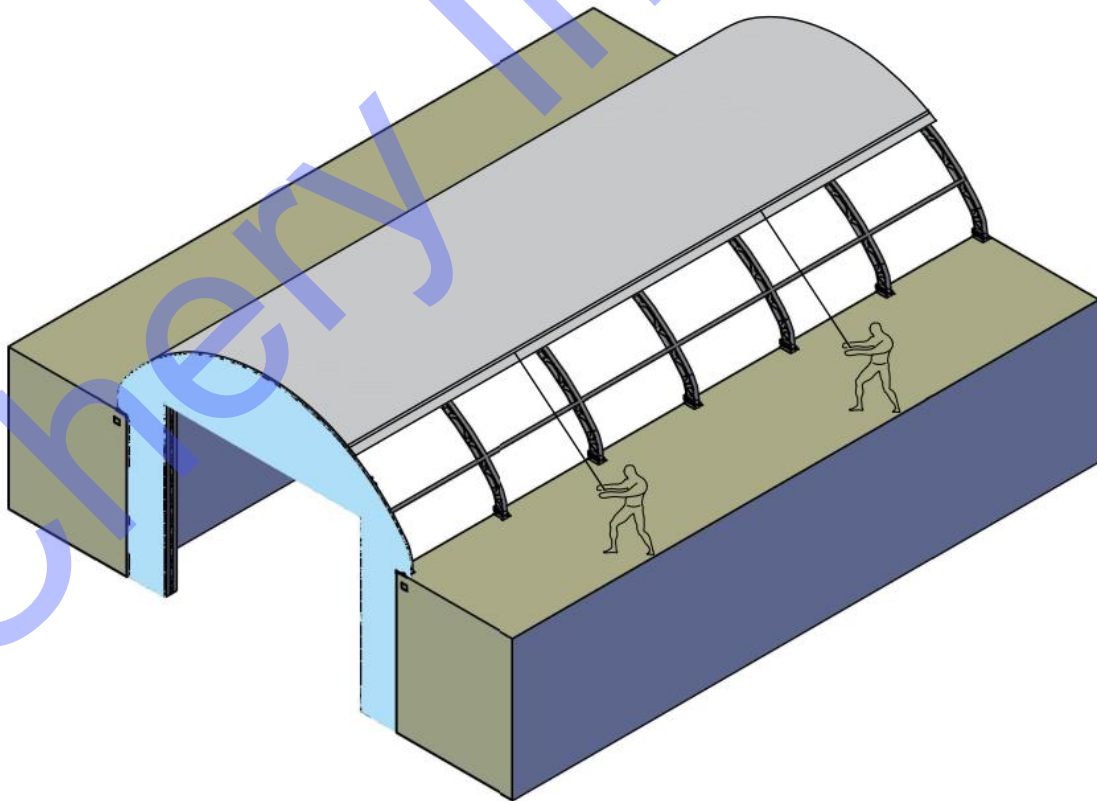

C2040S Front winch door Spare Part List		
No.	Description	QTY
1	Top bent tube	6
1A	Top bent tube for front wall	1
2	Lower bent tube	12
2A	Lower bent tube for front wall	2
3	Purlin	30
4	Bottom tension tube	2Group
5	Ratchet	14
5A	Rachet Straps	14
6	Angle seat Welded with hook	4
7	Base Plate for winch door	2
8	Side base plates for both end wall	2
9L	Left Base Plate	7
9R	Right Base Plate	7
10L	Bottom Winch Door Track at left	1
10R	Bottom Winch Door Track at Right	1
10	adding door track for 40'HQ container	2
11L	Upper Winch Door Track at left	1
11R	Upper Winch Door Track at right	1
12	Beam for winch door	1Group
12A	Suspending tube for winch door	1

12B	Dropping tube for winch door	7Groups
13	Side standing legs for endwall	1
13A	Right Standing leg for front wall(connect the winch wheel tube)	1
14	adding standing leg for 40'HQ container	2
15	Supporing tube for front wall	2
15A	Winch wheel tube	1
15B	winch wheel with wire rope	1
16	bottom tension tube for front wall	2
22	connection parts for side standing leg	2
23	Stake pegs	16
25A	Plastic Plug	8
26	rope	1
27	Bolts M12*30mm	74
28	Bolts M10*90mm	18
29	Bolts M10*60mm	10
30	Bolts M10*30mm	28
31	Carriage bolts M8*60mm	48
32	Roof Cover	1
33	Front Cover	1

SPECIFICATION

Wide: 6m

Length: 12m

Height: 2m

IMPORTANT-----READ MANUAL FIRST

Improper site preparation, Assembly and Maintenance may invalidate warranty and cause unnecessary and costly mistake. If you have any questions contact your local dealer.

For User Friendly assembly we have identified each individual component with the part code as indicated in the parts list. Please refer to the part code numbers and drawing to ensure problem free assembly.

It's necessary to tighten the roof fabric enough to avoid "hammocks" on the roof and also re-tighten once or twice again after a few months of use. This is important when assembly in cold weather (autumn and winter) because the fabric is stiff then and when we got the sun and warm weather afterwards it will make the fabric "slack" again and need to be re-tighten before next winter.

It's the owners responsibility to take of snow immediately if not slide off by itself.

READ ALL INSTRUCTIONS BEFORE ASSEMBLY

1. Keep work area clean. Cluttered areas invite injuries. Do not set up near snow drifts, in slippery places, in high winds, or wet location.
2. Keep children away. All children should be kept away from the work area.
3. Don't over reach. Keep proper footing and balance at all times.
4. Do not assemble in under the influence of alcohol or drugs. Read warning labels on prescriptions to determine if your judgment or reflexes are impaired while taking drugs. If there is any doubt, do not assemble.
5. Be aware of possible windy conditions; fasten the bases in concrete if these conditions are likely to occur. Remove the cover during hurricane.
6. Be careful with power and heat sources. Do not keep heat sources near the tarpaulin. Do not expose to open flame.
7. Be aware of personal safety during assembly and use. Be careful not to pinch fingers with clips and tubes when assembling: when using makes sure there is adequate ventilation for exhaust and other dangerous fumes.

● EQUIPEMNT AND TOOLS FOR INSTALIATION

1. Measuring tape
2. String for alignment
3. Step ladder
4. Welder
5. Sledge hammer
6. Wrench
7. Scissors

INSTALLATION PROCESS

A—BASE INSTALLATION

Please refer to the diagram (Figure 1) to place the base plates. UNIT: m

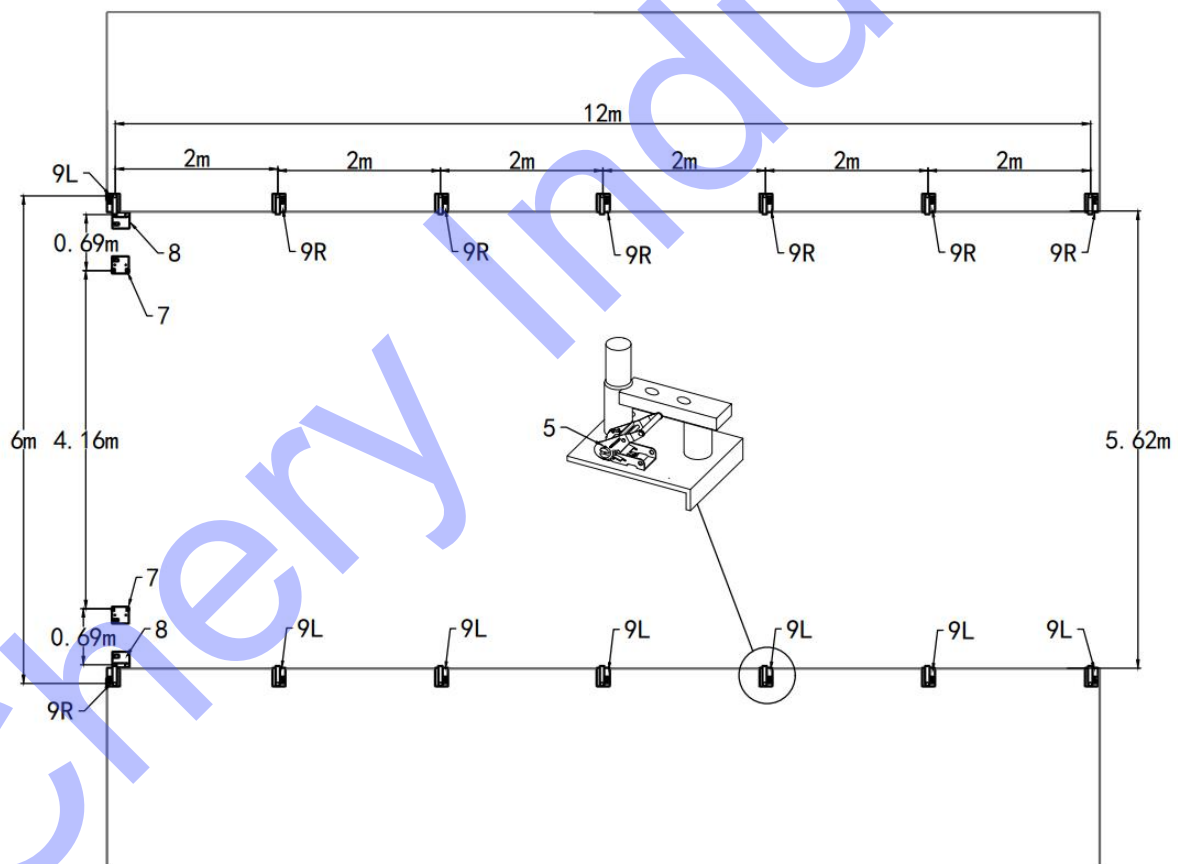

Figure 1

1. The measure if from center to center of the tubes. Referring to the above diagram and

confirm the place of the base plates. ENSURE THAT THE FOUNDATIONS IS SQUARE.
2. All the base plates need to use welder to be welded on the Containers.

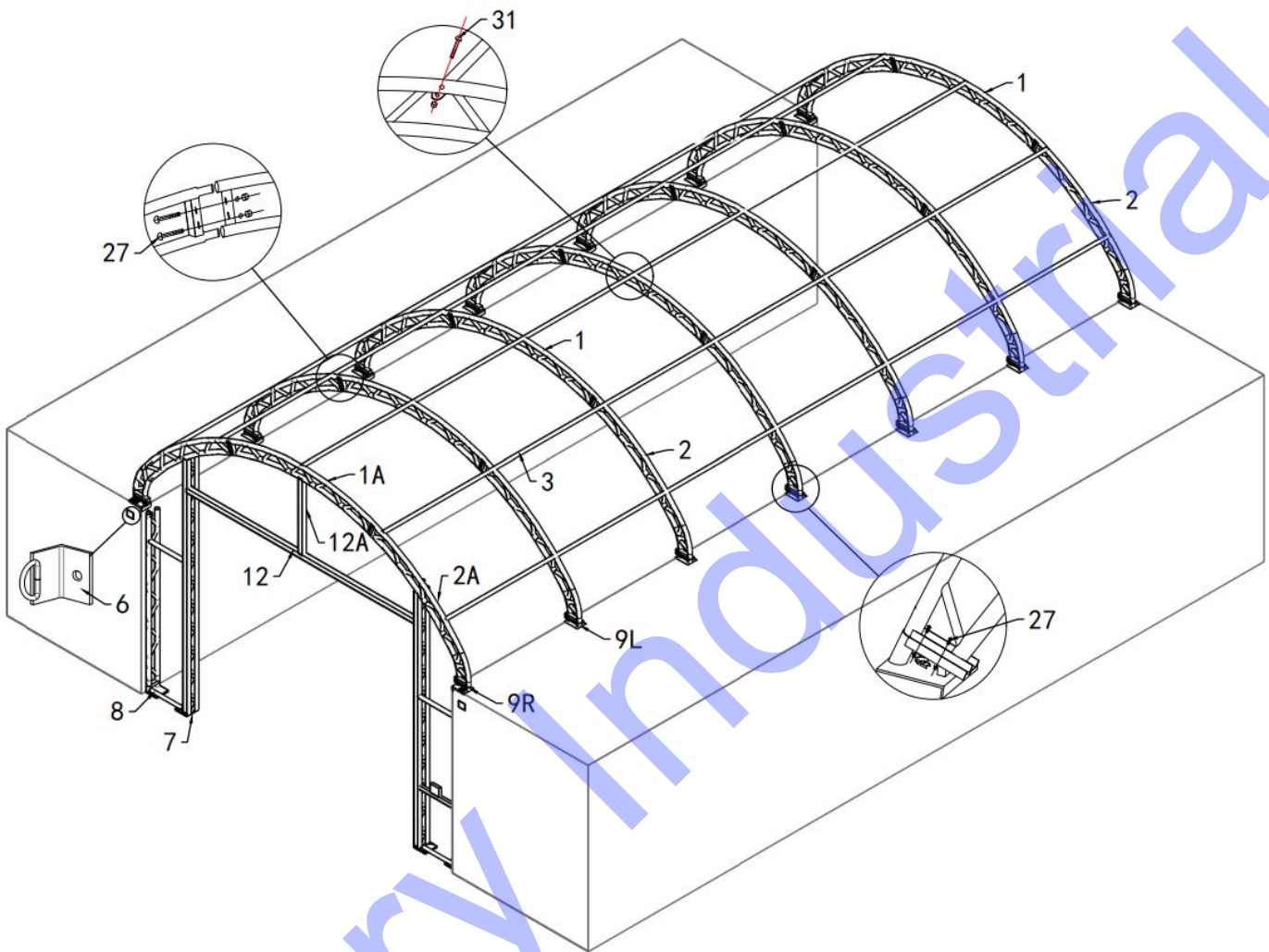

Figure 2: Size: W6 x L12 x H2m

B— FRAME INSTALLATION

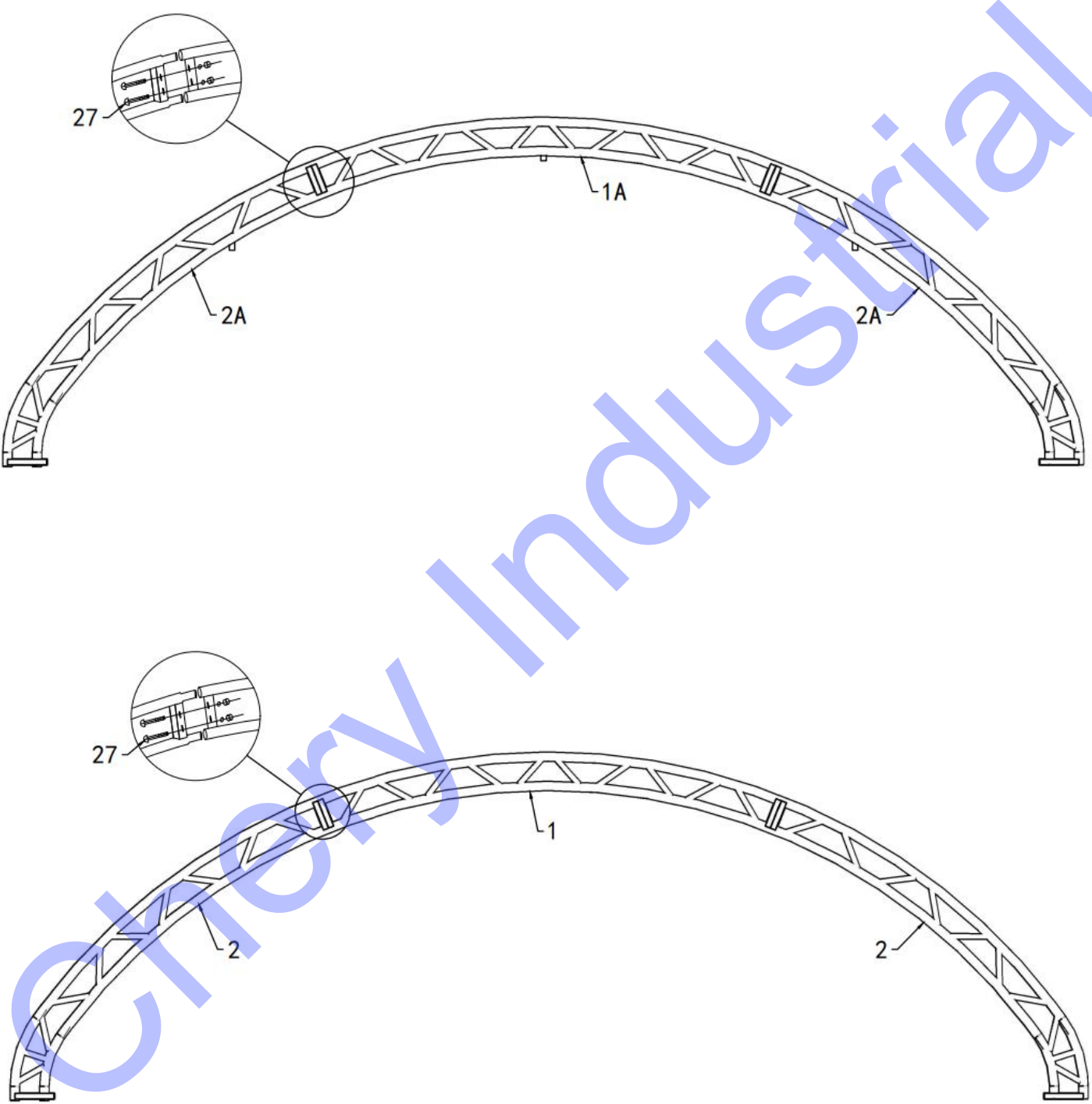

Figure 3

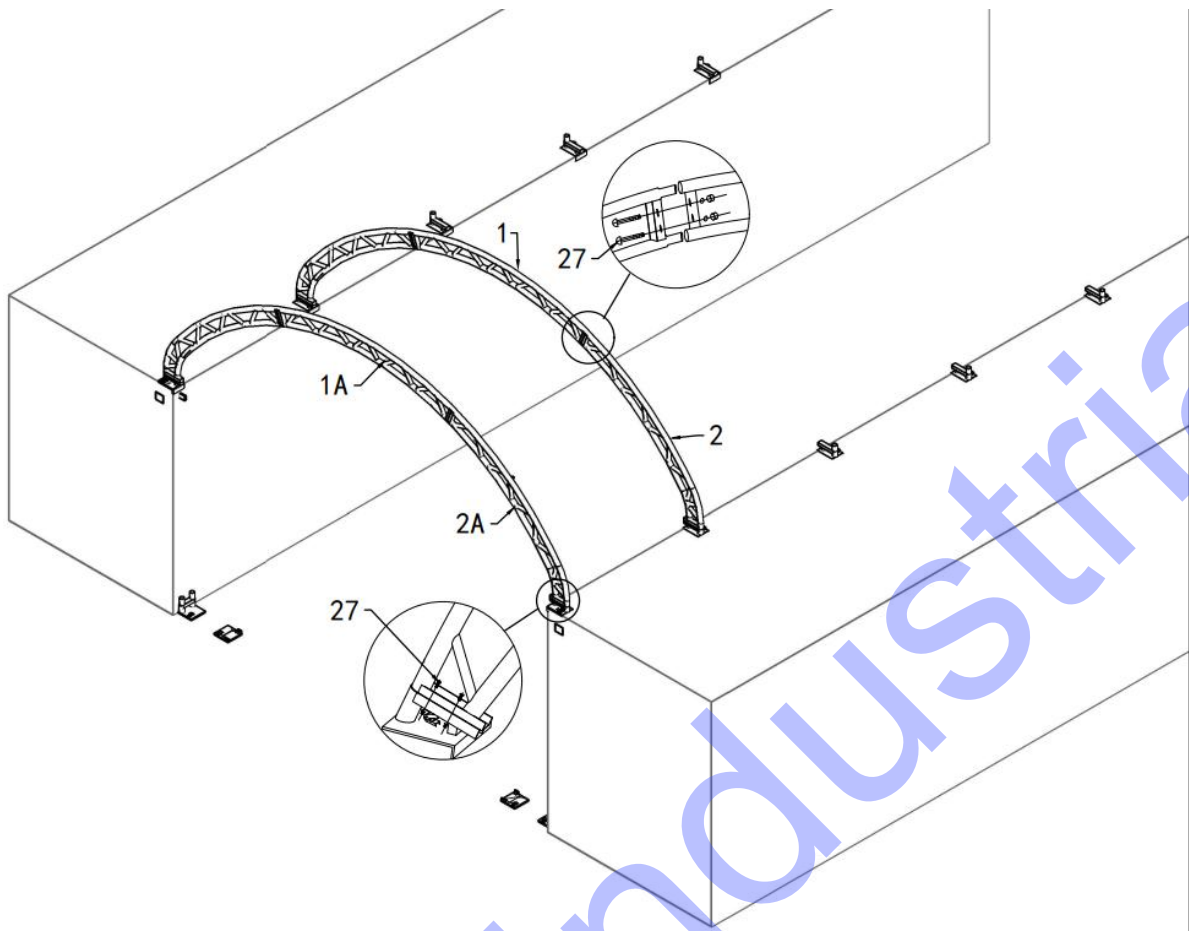

Figure 4

1 .As Figure 3 shown to connect Top bent tube(NO.1/1A) ,Bottom bent tube(NO.2/2A) by using Bolt M 12*30mm(NO.27),which makes one and two group of arches.

2. As Figure 4 shown to connect the arches and base plates with Bolt M 12*30mm(NO.27)

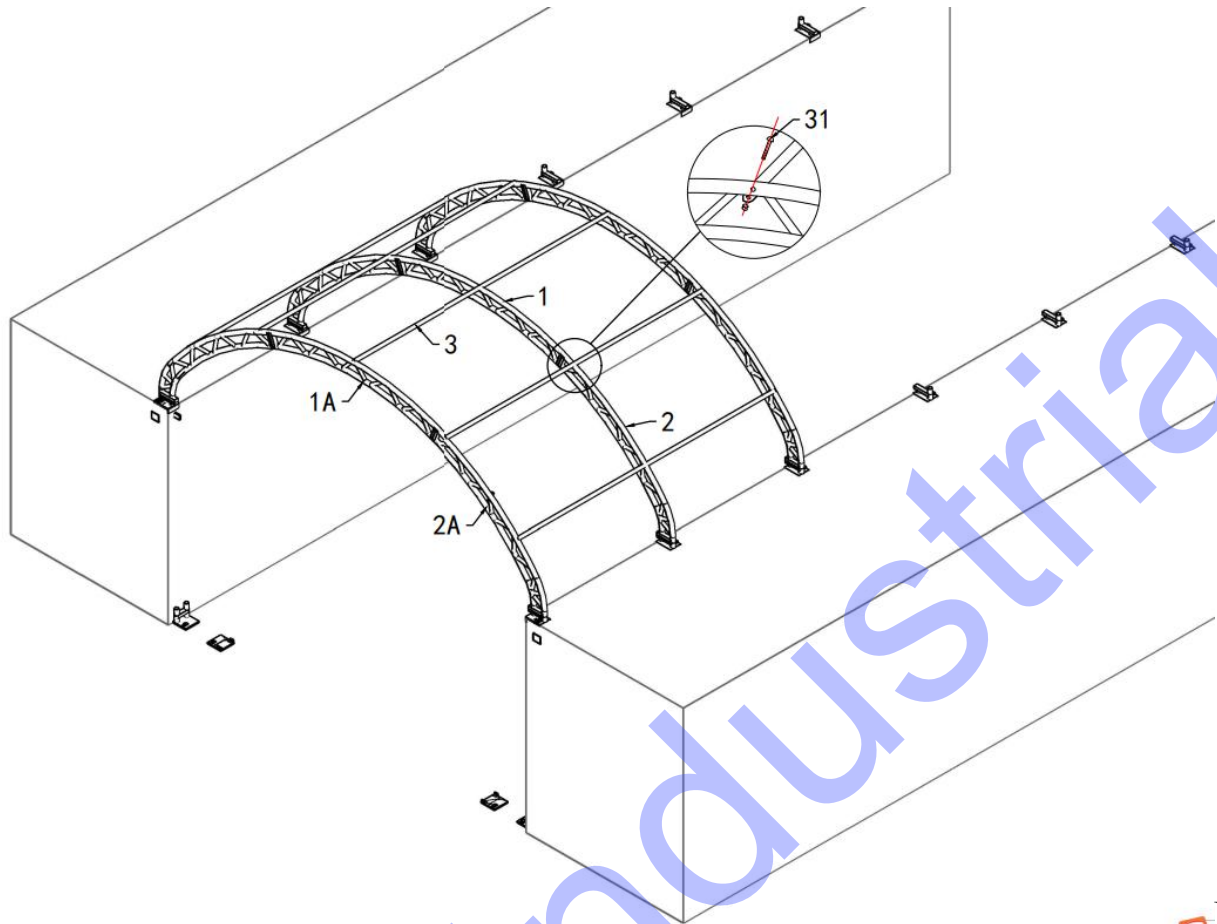

Figure 5

3. As Figure 4 shown, After finish installing the first two arches, connect the Connection purlin NO.3 on them by using NO. 31 Carriage Bolt M8*60mm. Then install the third arch into base plate and connect of her purlins. Do one by one.

C-Assembly Front Endwalls

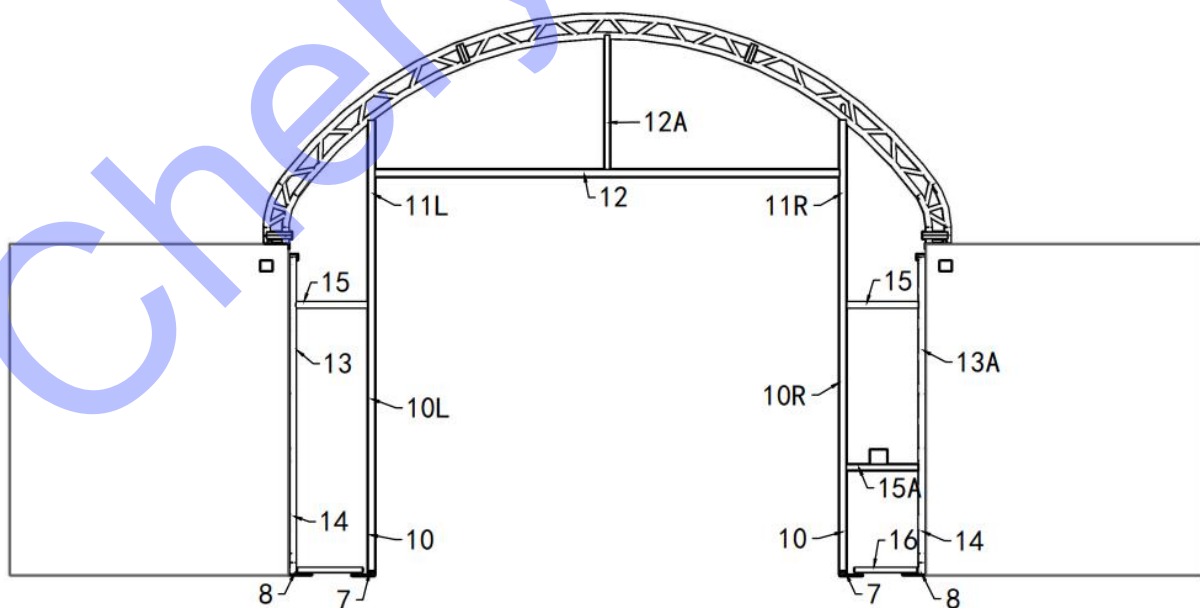

Figure 6

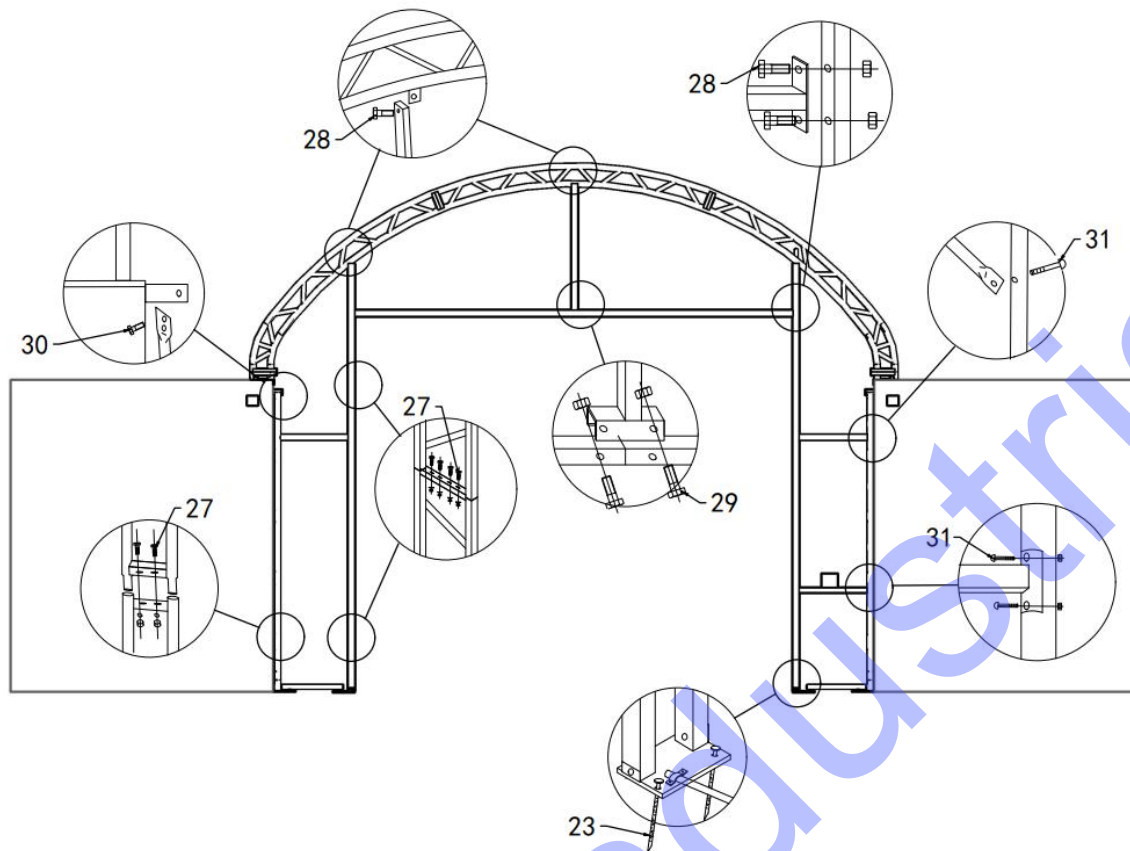

Figure 7

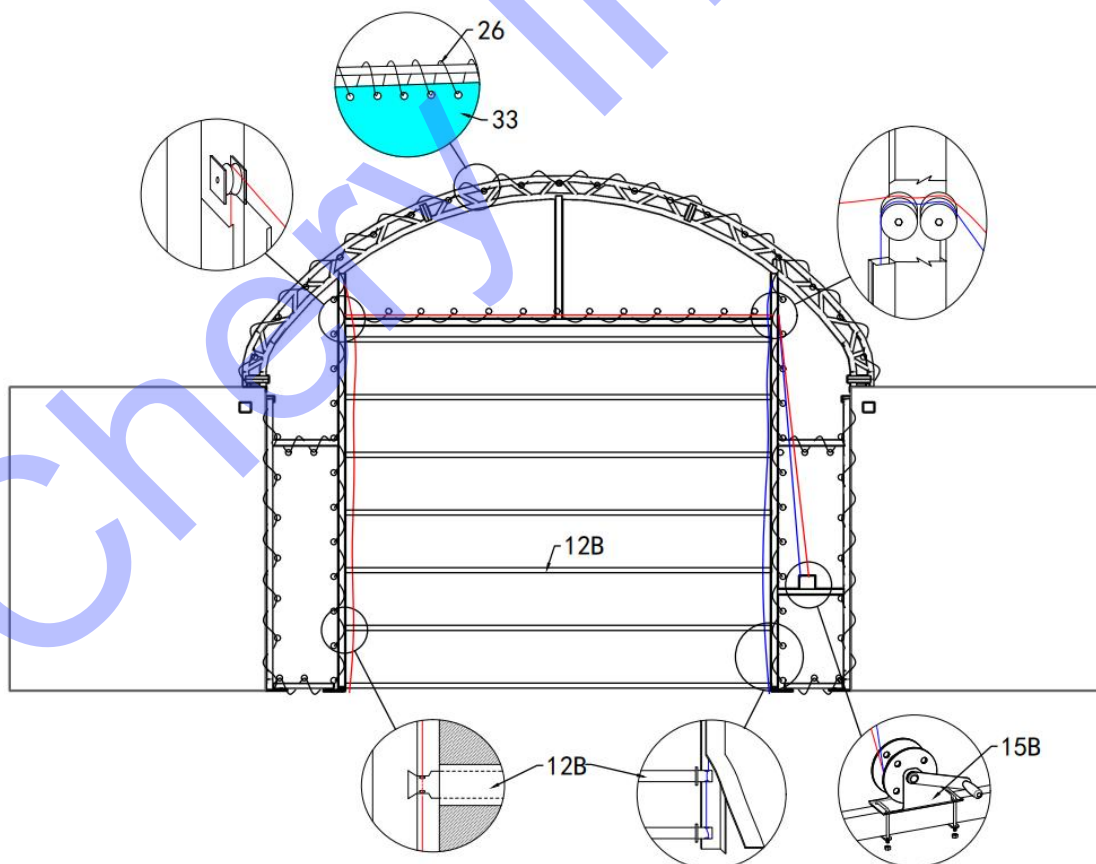

Figure 8

AS figure 6.7.8 shows, find our the spare parts for front wall with winch door,and assembly as per the drawing shows, use rope to tie the front wall cover (NO.33) to the frame.

D—INSTRUCTION THE ROOF COVER

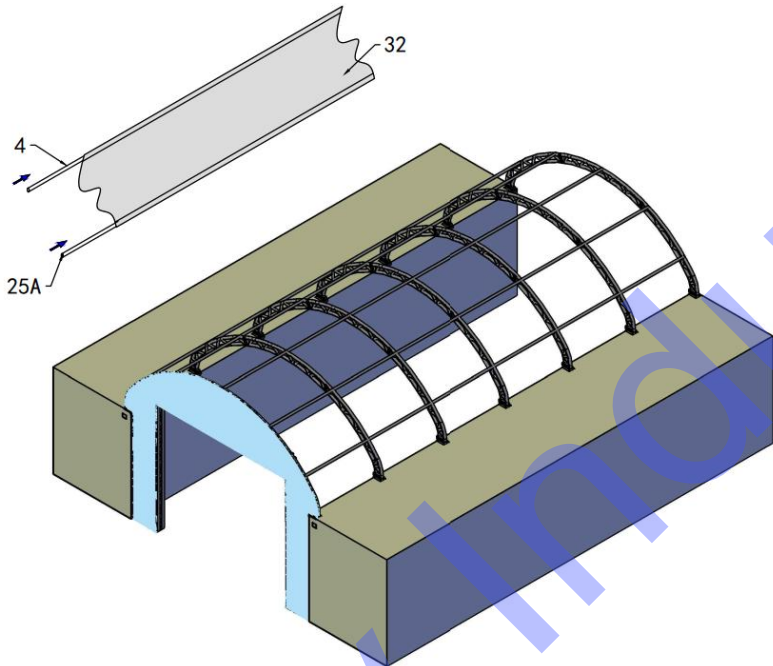

Figure 9

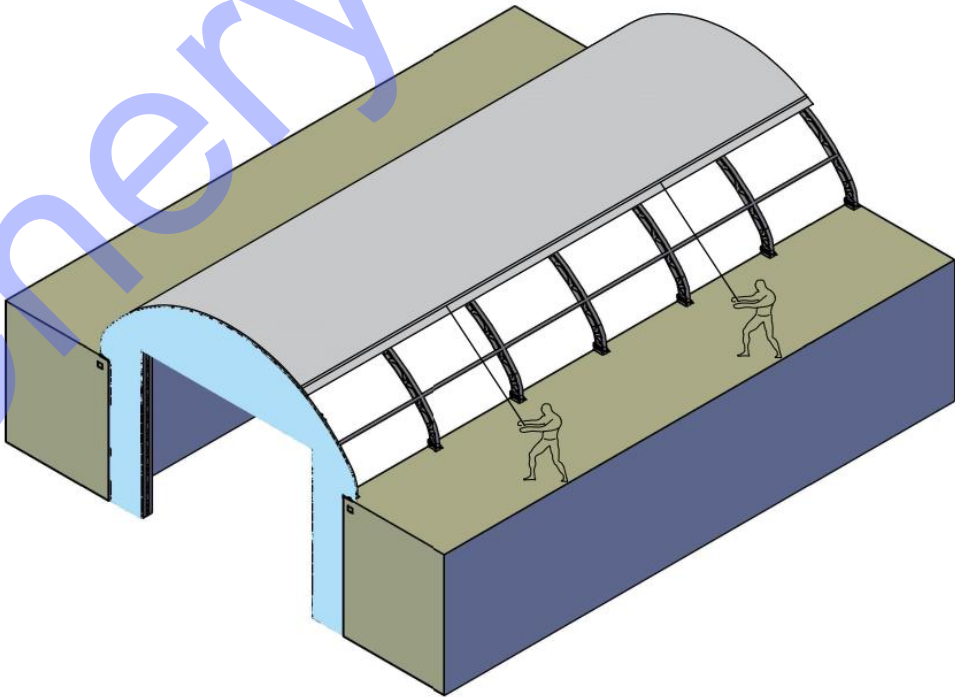

Figure 10

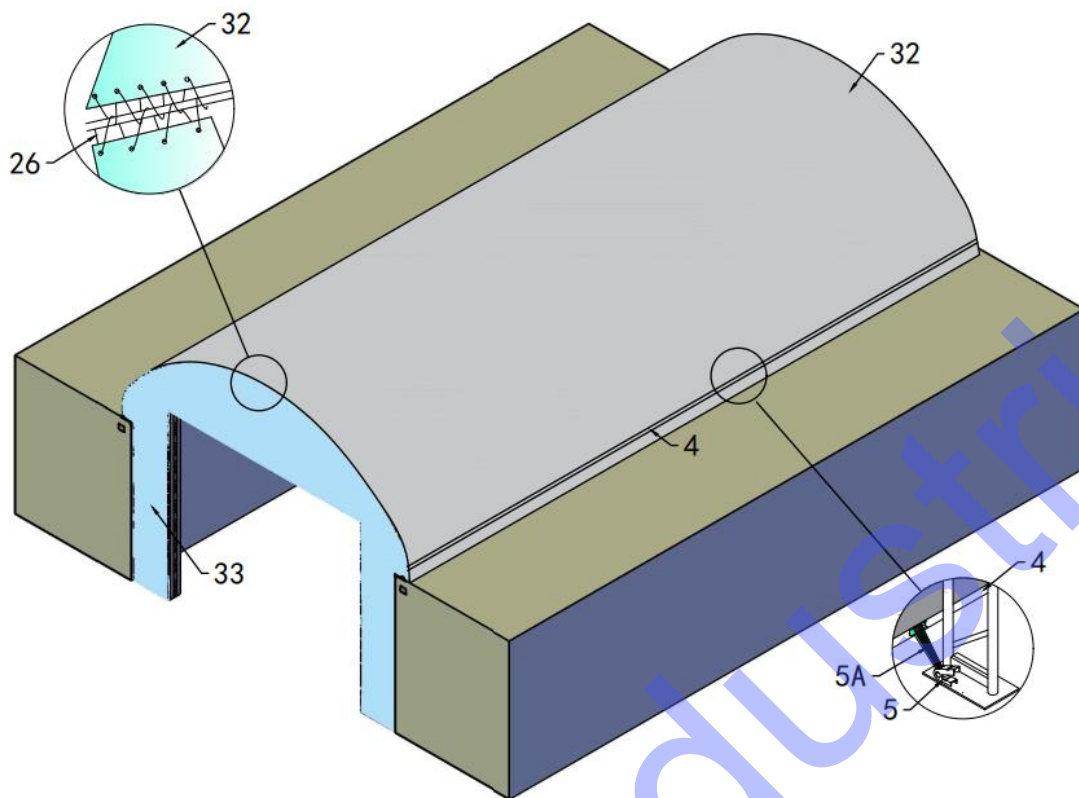

Figure 11

NOTE: DO NOT install the cover onto the frame of your building in high wind conditions. A slight breeze is the most advantageous for cover installation. To take advantage of the breeze, pull the cover up over the arches with the breeze blowing in the cover like a sail filled with air.

1. Put the Roof cover (Part No.32) EVENLY, CARRFULLR AND SLOWLY on the frame. Adjust the cover so that it is square and evenly centered on the frame.
2. Weld the Angle seats on each container and tie the Roof cover to the Angle seats. Finally install the ϕ 32 Plastic plug for base rail section into two end of the Lower Tension tubes.
3. Cut pockets according to the position of the base plates and put the Lower Tension Tubes for roof cover (NO. 4) into the pocket of roof cover. Then use the Ratchet Straps (NO.5A) to tie down the Lower Tension Tubes .

NOTE: DO NOT LEAVE THE ROOF COVER UNATTACHED UNDER ANY CIRCUMSTANCES until the final assembly and tightening has been completed. The process is quite easy. But some tightening adjustments will be necessary to produce a flat, tension ed roof cover. Please adjust the roof cover every month.